

Inductive Bulb Transducer

for cylinder mounting in hydraulics and pneumatics

DPL (pressure proof up to 200 bar)

MESSOTRON

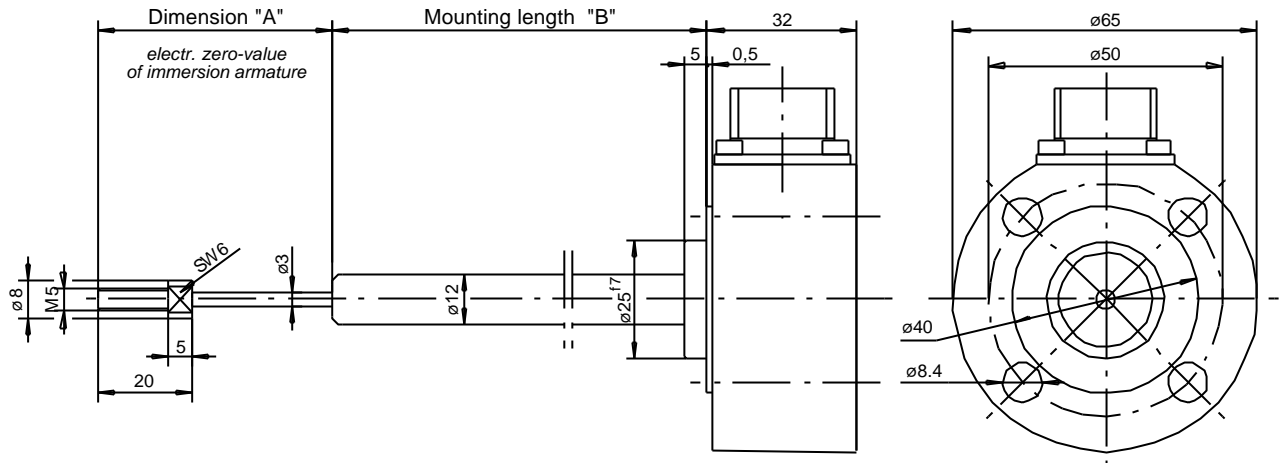

radial wire interface

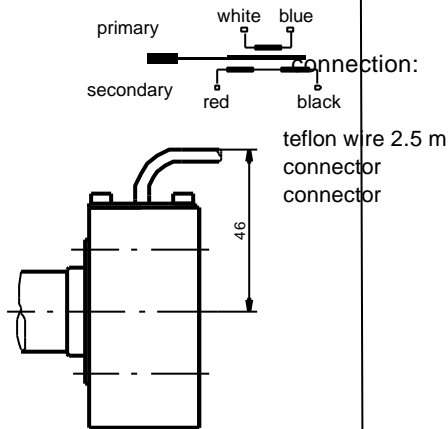

Example: DPL 150 Q 0.5%

radial connector interface

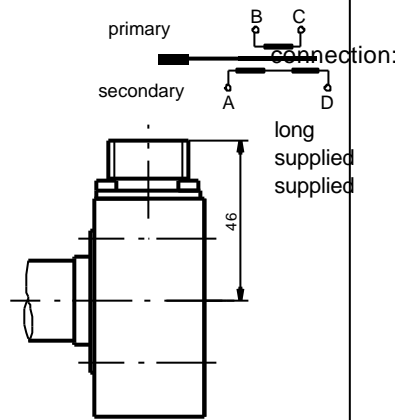

Example: DPL 150 R 0.25%

axial connector interface

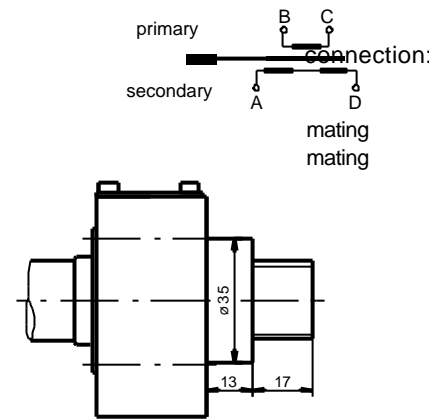

Example:

		DPL 50	DPL 100	DPL150	DPL 200	DPL 250	DPL 300	DPL 400
Electrical stroke	mm	±25	±50	±75	±100	±125	±150	±200
Max. mechanical stroke	mm	55	105	160	210	260	320	420
Dimension A	mm	55	80	105	130	155	180	230
Mounting length B	mm	100	140	220	300	380	480	600
Transducer weight	g	730	750	830	870	900	950	950
Plunger weight	g	14	16	20	25	28	30	35
Excitation voltage		1 ... 5 Veff						
Excitation frequency *)		5 kHz option: 10 kHz						
Static resolution		virtually infinite						
Recommended amplifier		MBI 46.31						
Linearity *)		±0.5% F.S.O. option: ±0.25%						
Temperature coefficient of zero		±0.04% / 10K						
Temperature coefficient of span		±0.1% / 10K						
Pressure resistance		operating pressure 200 bar; test pressure 250 bar						
Operational temperature *)		-40°C ... +80°C, option: up to 120°C						
Protective system (DIN 40050)		IP 65						

*) select option when ordering

MESSOTRON
 Hennig GmbH & Co. KG
 Industrie-Messtechnik
 Friedl.-Evert-Str. 37, Tel.: (06257) 82331
 D-64342 Seeheim-Jugenheim

DPL Series
 50 ... 400 mm

Drawing
 28.28.00

Date 04/97

Design of transducers can be customised

Subject to change without prior notice