

Inductive Sensor WLH



Inductive half-bridge sensor LVIT

- 12mm standard housing
- economic design
- low temperature coefficient
- particularly suitable for general and testing actuator applications / test machines

Technical data

		WLH 1	WLH 2	WLH 5	WLH 10	WLH 20	WLH 40	WLH 50	WLH 100	WLH 150	WLH 200	WLH 250	WLH 300	WLH 400	WLH 500	
Nominal stroke	mm	±0,5	±1	±2,5	±5	±10	±20	±25	±50	±75	±100	±125	±150	±200	±250	
Mechanical stroke **)	mm	±2	±3	±6	±10	±15	±30	±30	±60	±90	±110	±135	±160	±210	±258	
Dimension A	mm	30	30	40	40	40	45	50	100	130	150	180	200	250	300	
Dimension B	mm	22	22	30	80	100	145	145	245	355	455	565	675	875	1065	
Sensor weight (ca.)	g	11	11	15	40	60	85	85	120	150	200	230	280	350	440	
Core weight (ca.)	g	2	2	3	6	8	9	9	12	15	20	25	30	40	50	
Nominal output	mV/V	30	80	110	90	130	180	240	290	310	330	310	320	320	350	
Sensitivity	mV/V/mm	60	80	44	18	13	9	9,6	5,8	4,1	3,3	2,5	2,1	1,6	1,4	
Excitation voltage	V eff	< 5														
Carrier frequency	kHz	5 ... 10														
Linearity *)		±0,5% FSO			±0,5% FSO											Option: 0,25% und 0,1%
Temperature coeff. of zero		±0,02% / 10K														
Temperature coeff. of span		±0,05% / 10K														
Operating temperature		-50°C ... +80°C, Option: up to 120°C														
Protection		IP 64														

*) Specify option on order

***) Mechanical stroke: Values beyond nominal stroke non specified; values non-applicable at inner end position on version "K"

Model list

Order code:

WLH

nnn

N

n,n %

/Option1 /Option2 ...

Series	Stroke	Connection				Linearity (FSO)			Options		
		Leads	Axial cable	Radial cable	Radial connector	0,5%	0,25%	0,1%	High operating temperature ¹⁾	PTFE cable ²⁾	Customised Dim. A
WLH	1 ... 500										
		o.	K	Q	R				/120°C	/TF	/A xx
X	1 ... 5	X	X	--	--	X	--	--	--	O	O
X	10 ... 500	X	X	X	--	X	X	X	O	O	O
X	10 ... 500	--	--	--	X	X	X	X	WLH...RS series	O	O

X = available standard model O = option -- = not available
 1) PTFE cable with versions K and Q 2) with versions K and Q only

Inductive Sensor WLH

Mechanical drawings

Leads ()

Core channel continuous

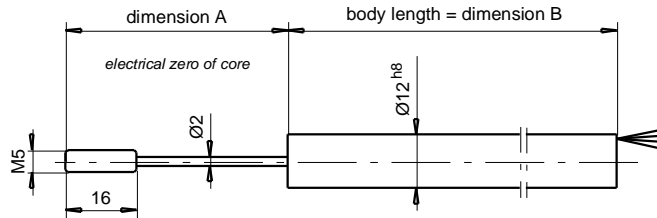

Axial cable (K)

Core channel not continuous

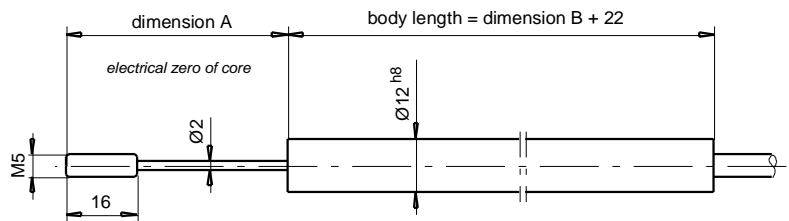

Radial cable (Q)

Core channel continuous

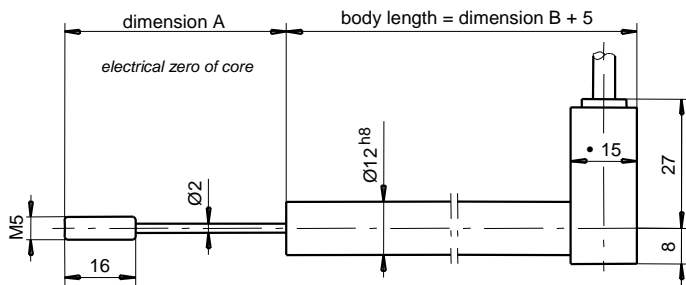

Radial connector (R)

Core channel continuous

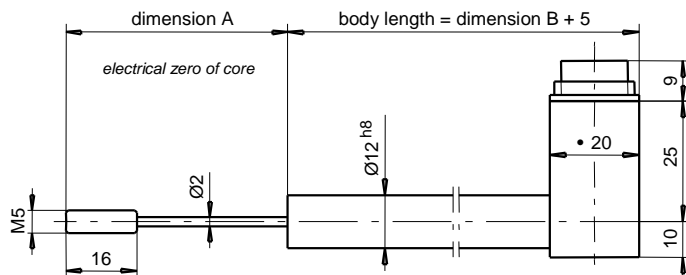

Connection

	Leads	K / Q	R
Type of connection	PTFE leads 250 mm long	PE-cable 2,5 m long Option: PTFE cable	Amphenol C 091 connector (Mating plug supplied)
Pin configuration			
Power supply +	Blue	Blue	3
Power supply -	Red	Red	2
Measuring signal +	White+Yellow	White	1
Measuring signal -	-	-	-
Mating plug	-	-	Amphenol C 091